



GENERAL FEATURES

- Rack dimensions: **50x60 cm**
- Net weight: 74 Kg
- Wash cycles / racks per hour: 2'- 3'- 6'- 9' / 30-20-10-7
- Stainless-steel wash/rinse arms easily removable
- Wash pump: 680 W
- Boiler capacity: 5,5 lt
- Tank capacity: 22 lt
- Boiler heating element: 6 kW
- Tank heating element: 2,4 kW
- Water quantity per cycle: 2 lt
- Useful washing height: 380 mm
- Electronic management with colour LCD display showing boiler and tank temperatures, multicolored start button and self-diagnostic system
- PRS System: built-in atmospheric boiler, independent from the water supply pressure, with rinse pump to guarantee constant rinse temperature and pressure throughout the entire rinse phase
- High efficiency air gap (A class)
- SD System: built-in drain pump, without overflow pipe, actioned automatically prior to the rinse cycle to guarantee clean tank water
- Double electric detergent and rinse aid dispenser
- Thermostop function (hot rinse)
- Green function for energy saving
- Automatic end of day self-cleaning cycle

WATER FILTRATION

- Pre-filtering of the tank water by means of Composite material filter
- Plastic wash pump filter, easily removable

BODY

- AISI 304 stainless-steel structure
- Double skinned body
- Preformed wash tank with rounded corners to avoid grime build-up
- Preformed rack guides
- 30/10 door reinforcement brackets for extra strength
- Boiler in stainless-steel AISI 316

STANDARD EQUIPMENT

- 1 stainless-steel trays rack (4 places)
- 1 utensil rack 50x60 cm
- 1 inlet hose (length 2 mt)
- 1 drain hose (length 2,5 mt)

OPTIONS

- HD version (9,08 kW in 380-415V 3N~)
- Built-in automatic water softener (S)
- Hot water filling max 85°C (HW)
- Chemicals level sensors (CLS)
- Wi-Fi connection (WIFI)
- KIT high feet (95÷140mm)
- 60 Hz version

WATER TREATMENT ACCESSORIES

- Automatic water softener

ACCESSORIES

- Stainless steel stand H 550 mm
- Special racks

WATER SUPPLY CONNECTION

- **Water supply hardness:**
Water hardness between 0 and 14°f (0 ÷ 8°d)
Above 14°f (8°d) suggested water softener
- **Water supply dynamic pressure:**
Standard between 1 and 5 BAR
With built-in water softener between 1 and 4 BAR
- **Water supply temperature:**
Standard between 10 and 60°C
With built-in water softener between 10 and 25°C

MAIN POWER SUPPLY

- The voltage of main power supply must be compatible with the rated voltage
- The machine must be connected to a suitable earth (ground) system
- Connect the machine power socket to the multi-pole wall switch provided

TECHNICAL SPECIFICATIONS

- Electrical supply: **380-415V 3N / 220-240V3 / 220-240V~ 50 Hz (MULTIPOWER)**
- Total power: **6,68 kW (9,08 kW in HD)**
- Absorbed current: **12 A / 18 A / 30 A (22 A IN HD)**
- Power cord supply size: **5 x 2,5 mm² / 3 x 4 mm²**

AU 60.40 EPI PRS SD

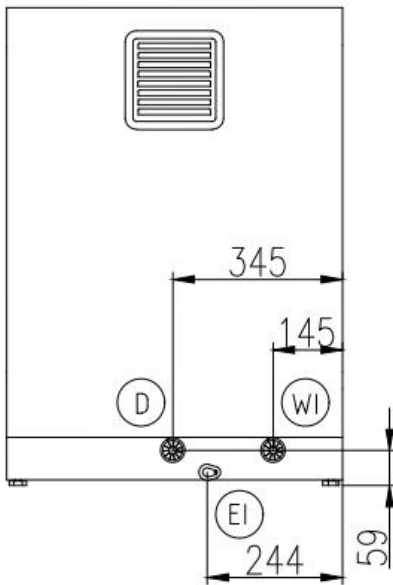
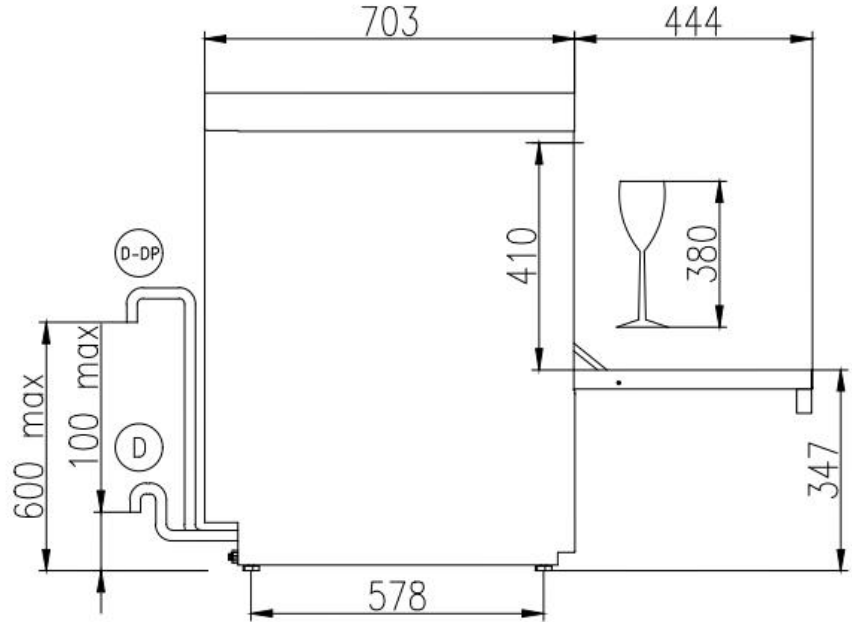
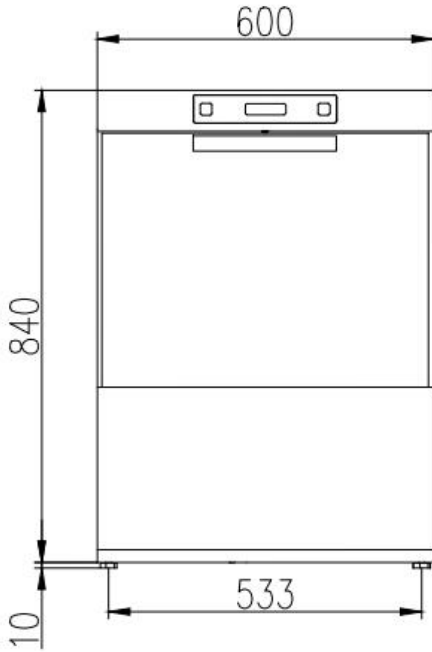

- EI CAVO DI ALIMENTAZIONE
 POWER CORD SUPPLY
 CABLE D'ALIMENTATION
 CABLE DE ALIMENTACION
- WI CANNA DI CARICO G 3/4 L=2000 mm
 G 3/4 INLET HOSE L=2000 mm
 TUYAU D'ALIMENTATION G 3/4" L=2000 mm
 TUBO DE ALIMENTACION G 3/4" L=2000 mm
- D TUBO DI SCARICO ø 29 mm L=2500 mm
 DRAIN HOSE ø 29 mm L=2500 mm
 TUYAU DE VIDANGE ø 29 mm L=2500 mm
 TUBO DE DESAGUE ø 29 mm L=2500 mm
- D-DP TUBO DI SCARICO ø 29 mm L=2500 mm (CON POMPA SCARICO)
 DRAIN HOSE ø 29 mm L=2500 mm (WITH DRAIN PUMP)
 TUYAU DE VIDANGE ø 29 mm L=2500 mm (AVEC POMPE DE VIDANGE)
 TUBO DE DESAGUE ø 29 mm L=2500 mm (CON POMPA DE DESAGUE)

	Min 10°C-MAX 60°C
	Min 10°C-MAX 25°C with energy recovery and water softner
	200÷500kPa(2÷5 Bar)
	100÷500kPa(1÷5 Bar) with atmospheric boiler
	HARDNESS 5 ÷ 14'f - 2.8 ÷ 8'd